

MicroCAM – M402 FHD PLUS

On-the-move ANPR+MMR Rooftop single-cable (PoE+) camera

Model	M402 FHD PLUS (16 mm)	M402 FHD PLUS WIDE (4.5mm)
Imaging		
Maximum resolution (HxV pixels): framerate	2048 x 1536: 20fps 1920 x 1080: 30 fps	
Day/night switch	Light sensor, configurable quick auto-switching day/night mode, automatic brightness control	
Lens	Fixed 16 mm	Fixed 4.5 mm

Distance Range

Optimal ANPR range at ambient light	8 m – 15 m (26.2 feet – 49.2 feet)	1 m – 4 m (3.3 feet – 13.1 feet)
Maximal ANPR range at optimal conditions	20 m (65.6 feet)	5 m (16.4 feet)

Illumination

Wavelength	850 nm (infrared)
Illumination modes	Synchronized flash

Processing & I/O

CPU for ANPR	ARM Quad Core 64-bit, 4 x 1GHz
Communication protocols	ONVIF, ARP, TCP/IP, DHCP, NTP, FTP, HTTP, RTSP, HTTPS, SFTP, DNS, SNMP, SSL/TLS, NTCIP

Electrical Data

Power requirement	PoE+ (IEE 802.3at)
Connectivity	Single cable with RJ45 connector (data and power)

On-Board Intelligence

CARMEN® ANPR	Included
CARMEN® Make and Model, Color Recognition	Optional
Video analytics	Included
Trigger sources	Video Analytics / Software trigger (controlled via HTTP or HTTPS request)
GDS compliant	Yes
Data storage	32 GB internal SSD, ~ 50 000 - 100 000 event

Mechanical Data

Internal operating temperature	-30 °C – +70 °C (-22 °F – +130 °F)*
IP rating	IP67
Dimensions (with bracket) L x W x H	183 mm x 160 mm x 96 mm (7.2" x 6.3" x 3.8")
Weight t (with bracket)	2.0 kg (4.4 lbs)
In the box	Camera with 5 m cable, bracket, shield.

Optional Accessories

Optional accessories	Adapter for stationary use (tripod or wall-mount camera bracket)
----------------------	--

Certificates

Certificate	CE, FCC Class A
-------------	-----------------

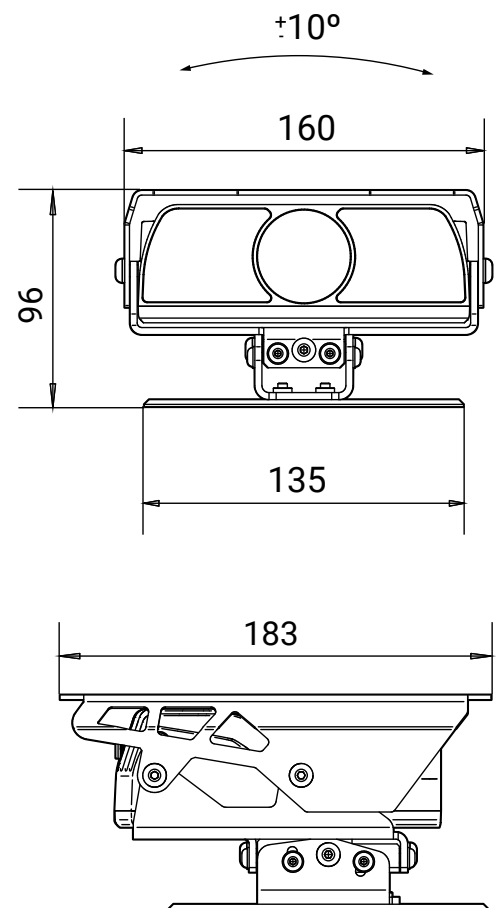

On-Board ANPR+MMR, powered by:

3-year warranty
Made in EU

*internal temperature / ambient temperature: max. 55 °C (131 °F)

Technical specifications are subject to change without prior notice. This document does not constitute an offer.